

453

Beryllium window proportional counter

GENERAL SPECIFICATIONS

MAXIMUM LENGTH (INCH/MM)	4.31/109.47
MAXIMUM DIAMETER (INCH/MM)	1.5/38.1
GAS FILLING	Argon
EFFECTIVE LENGTH (INCH/MM)	2.0/50.8
CATHODE MATERIAL (INTERNAL/EXTERNAL)	Aluminum
EFFECTIVE DIAMETER (INCH/MM)	1.43/36.32
CONNECTOR	MHV
OPERATING TEMPERATURE RANGE °C	-40 to +75
GAS PRESSURE (TORR)	800
PATH LENGTH (INCH/MM)	1.43/36.32

WINDOW SPECIFICATIONS

MATERIAL	Beryllium
-----------------	-----------

THICKNESS (INCH/MM)	0.002/0.05
AREAL DENSITY (MG/CM ²)	9.2
DIAMETER (INCH/MM)	0.75/19.05

ELECTRICAL SPECIFICATIONS

RECOMMENDED OPERATING VOLTAGE (VOLTS)	1800
OPERATING VOLTAGE RANGE (VOLTS)	1700 - 1950
CAPACITANCE (PF)	3
TYPICAL RESOLUTION (FWHM FE55)	18

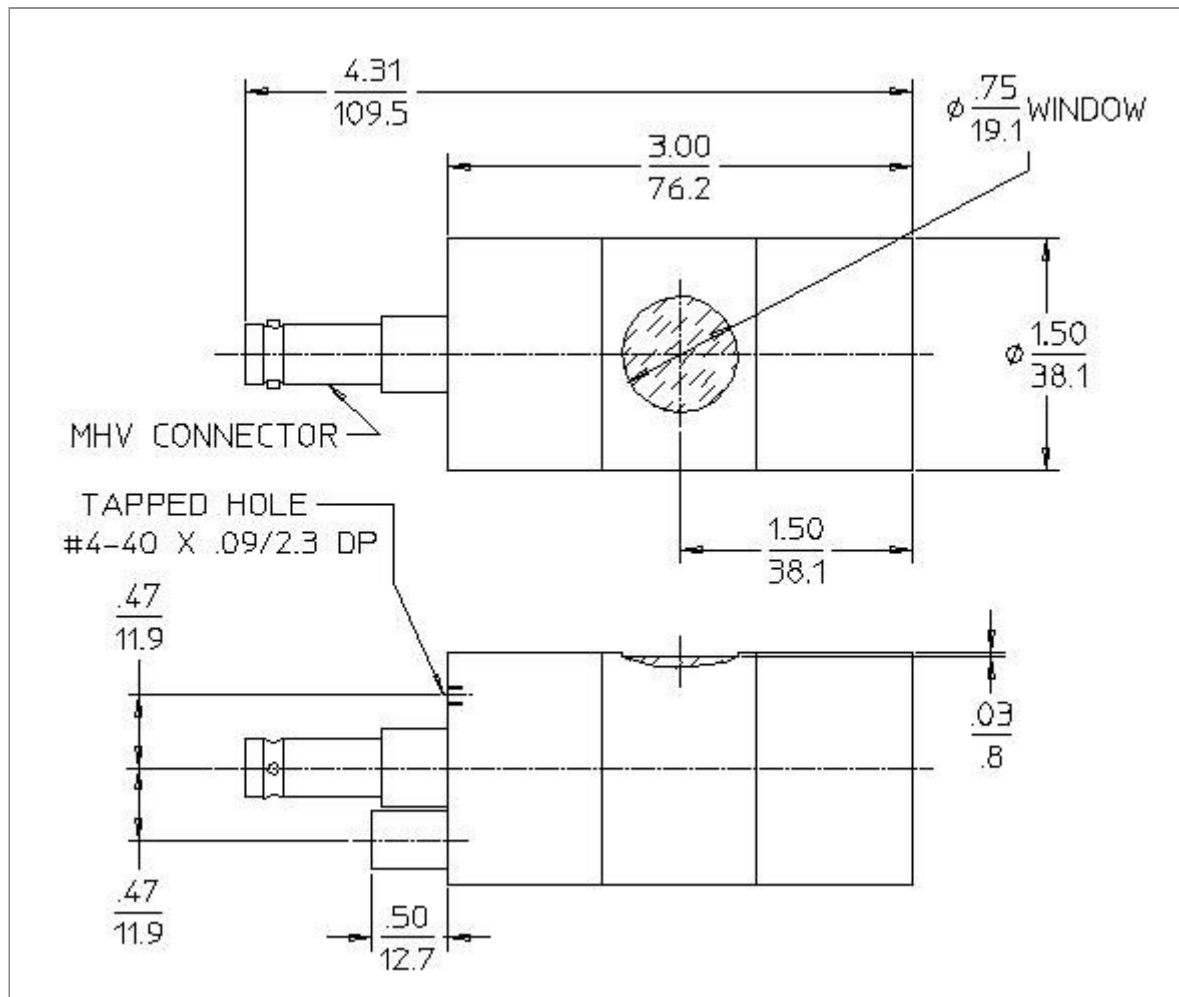

LND 453 BERYLLIUM SIDE WINDOW P.C.

